

# Strata Plan Of Lot A, Victoria City Plan VIP 77905

B. C. G. S. 92B. 044

Sheet 1 of 8 Sheets  
Strata Plan VIS **5679**

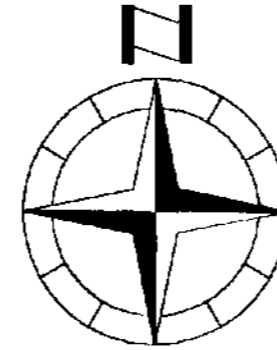

Scale = 1:750



Deposited and Registered in the  
Land Title Office at Victoria, B.C.  
this 15 day of November 2004

*M. Krantz*  
Registrar

This Plan Lies within the  
Capital Regional District  
and The City of Victoria

Civic Address  
1030 Yates Street

*EWIS2861  
DB*

Distances are in Metres.  
Bearings are derived from observations between  
Control Monuments 16-102 & 16-96  
Integrated Survey Area No. 17, City of Victoria  
This Plan Shows Ground Level Measured Distances.  
Prior to Computation of U.T.M. Coordinates  
Multiply by Combined Factor 0.9996080

**Legend:**

- ⊙ Denotes Control Monument Found
- Denotes Standard Iron Post (Type 5) Found
- Denotes Standard Lead Plug (Type 3) Found
- Pt. Denotes Part
- LCP Denotes Limited Common Property  
for use of designated lot
- SL Denotes Strata Lot
- m<sup>2</sup> Denotes square meters
- P Denotes Parking

**Endorsement Of Non-Occupancy**

I, Richard J. Wey, a British Columbia Land Surveyor,  
certify that the buildings included in this Strata Plan  
have not, as of the 6th day of October, 2004,  
been previously occupied.

*Richard J. Wey*  
Richard J. Wey B.C.L.S.

I, Richard J. Wey, of Sidney,  
a British Columbia Land Surveyor,  
hereby certify that the building shown  
on this strata plan is within the external  
boundaries of the land that is the  
subject of the strata plan.  
Dated at Sidney, British Columbia,  
this 12 day of October 2004

*RJW*  
B.C.L.S.

**Richard J. Wey & Associates,  
Land Surveying Inc.**

106 - 9717 Third Street, Sidney BC  
Telephone (250) 656-5155  
File: rich-971972.str

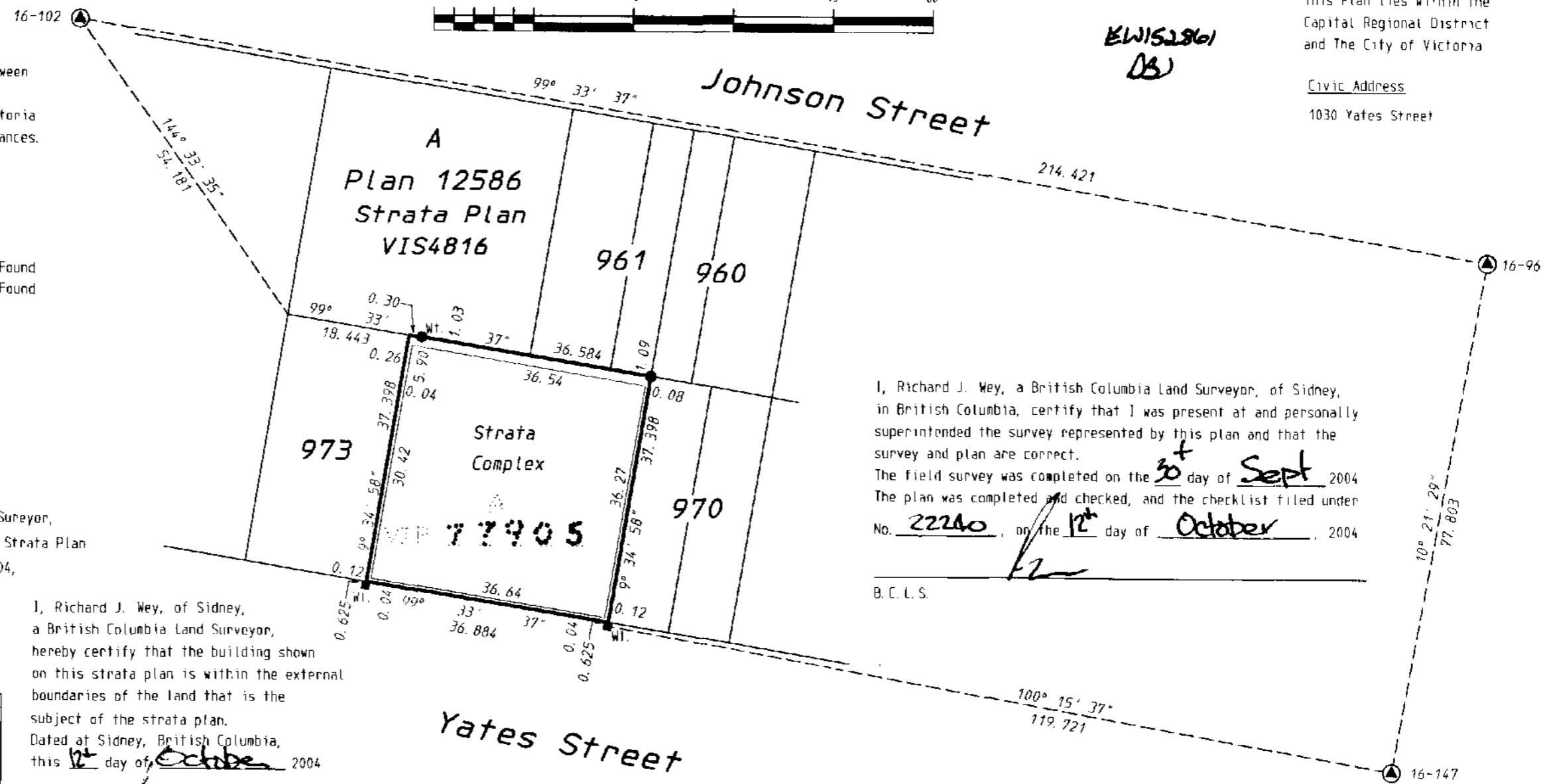

I, Richard J. Wey, a British Columbia Land Surveyor, of Sidney,  
in British Columbia, certify that I was present at and personally  
superintended the survey represented by this plan and that the  
survey and plan are correct.

The field survey was completed on the 30<sup>th</sup> day of Sept 2004  
The plan was completed and checked, and the checklist filed under  
No. 22240, on the 12<sup>th</sup> day of October, 2004

*RJW*  
B.C.L.S.

Sheet 2 of 8 Sheets  
Strata Plan VIS **5679**

Basement

Scale = 1:200



MORTGAGEE

Canadian Western Bank  
by its authorized signatory

*K. J. Cutting*  
**KENNETH J. CUTTING**

*S. Campbell*  
Witness **SHELLY CAMPBELL**

**MANAGER R/E ADMIN**

Occupation  
**22ND FL 1006 BURNARD ST  
VANCOUVER BC V6C 2X8**  
Address

MORTGAGEE

Canadian Western Trust Co.  
by its authorized signatory

*B. Gibbard*  
**BRUCE GIBBARD**

*S. Campbell*  
Witness **SHELLY CAMPBELL**

**MANAGER R/E ADMIN**

Occupation  
**22ND FL 1006 BURNARD  
VANCOUVER BC V6C 2X8**  
Address

Richard J. Wey & Associates

Land Surveying Inc.

4 - 2227 James White Blvd., Sidney, B.C.

Telephone (250) 656-5155

File: kin-971972b.str

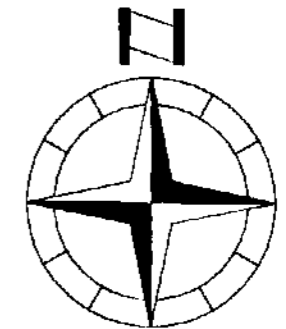
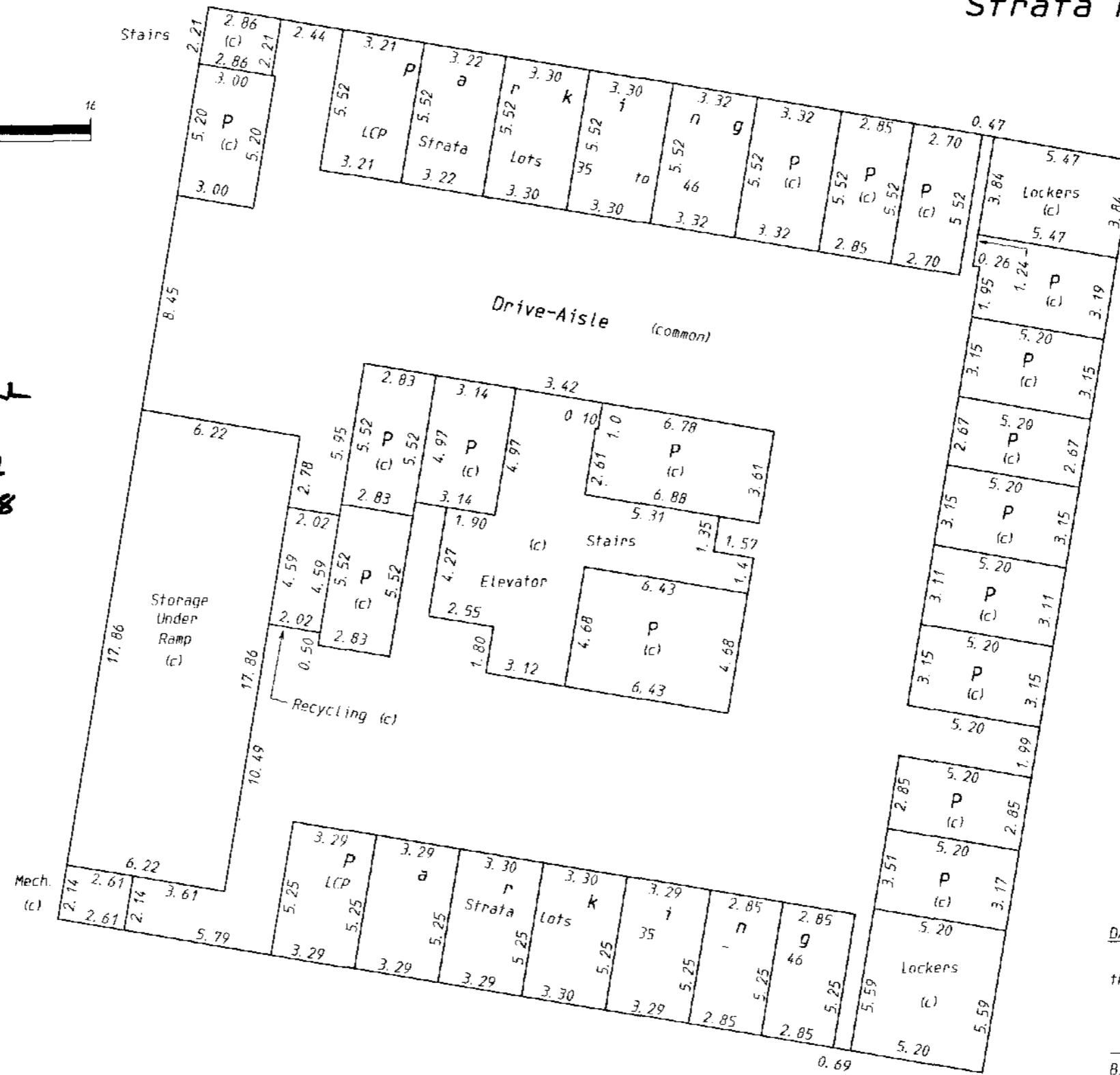

DATED

this 12<sup>th</sup> day of October 2004

*K*  
B. C. L. S.

Sheet 3 of 8 Sheets

Strata Plan VIS **5679**

First Floor

Scale = 1:200

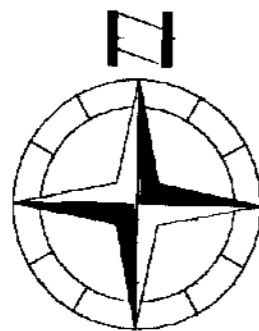
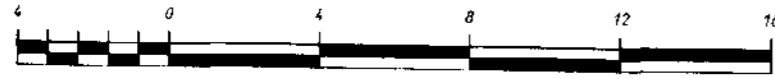

Registered Owners

*M. Webb*  
Martin Andrew Webb

*Stephen Webb*  
Stephen Russell Webb

*J. Pij*  
Witness

Occupation

Address

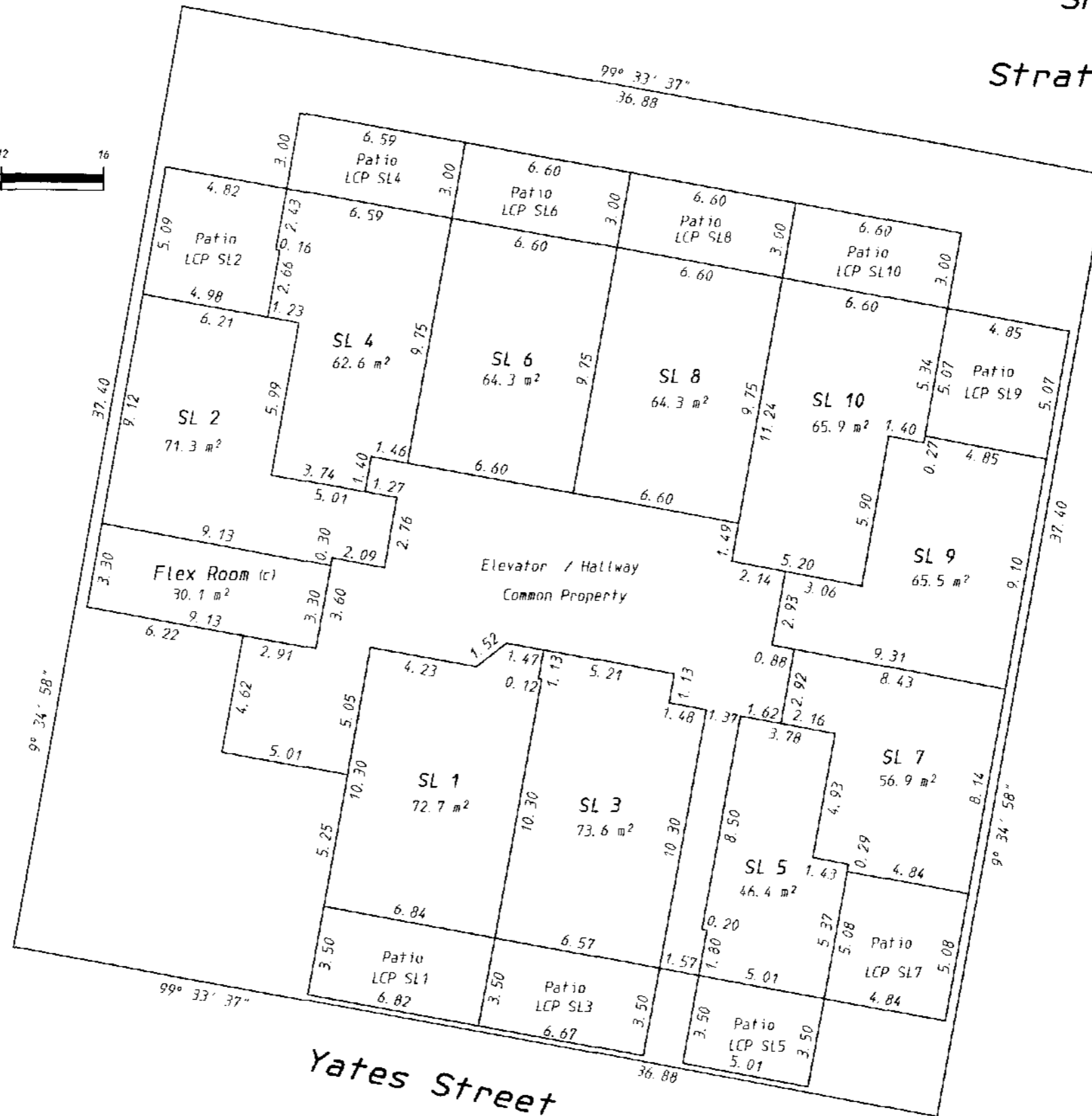

MORTGAGEE

Realtch Capital Group Inc  
Incorporation No. 268833  
by its authorized signatory

*David R. Boush*  
David R. Boush

*James C. McPherson*  
James C. McPherson

*Geraldine Dafe*  
Geraldine Dafe  
Witness

OFFICE MANAGER

Occupation

#1210-1030 W. Georgia St.  
Address  
Vancouver, B.C. V6E 2Y3

All balconies and patios are defined as to height by the centre of the floor above or its extensions, or where there is no floor above by the average height of a strata lot within the same building, unless otherwise indicated.

DATED

this 12<sup>th</sup> day of October 2004

*[Signature]*

B.C.L.S.

Richard J. Wey & Associates

Land Surveying Inc.

4 - 2227 James White Blvd., Sidney, B.C.

Telephone (250) 656-5155

File: rich-971972c.str

Yates Street

# Second Floor

# Sheet 4 of 8 Sheets Strata Plan VIS **5679**

Scale = 1:150

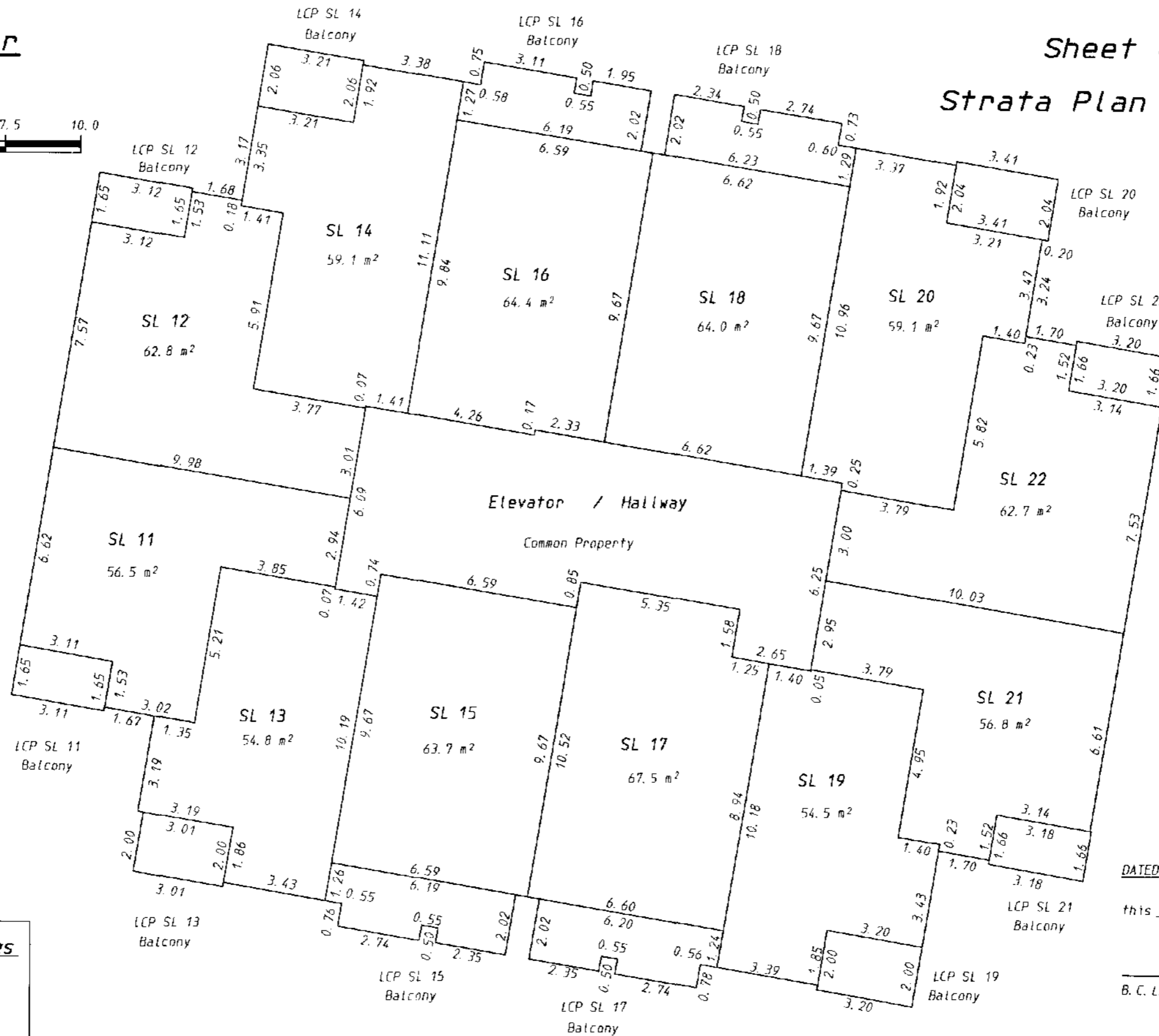
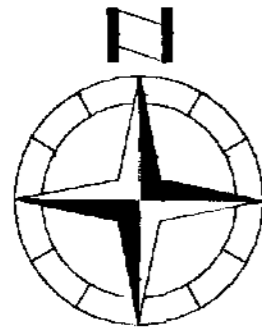

**Richard J. Wey & Associates**  
**Land Surveying Inc.**  
 4 - 2227 James White Blvd., Sidney, B.C.  
 Telephone (250) 656-5155  
 File: rich-971972d.str

DATED this 10<sup>th</sup> day of October 2004  
*[Signature]*  
 B. C. L. S.

Third Floor

Sheet 5 of 8 Sheets  
Strata Plan VIS **5679**

Scale = 1: 150

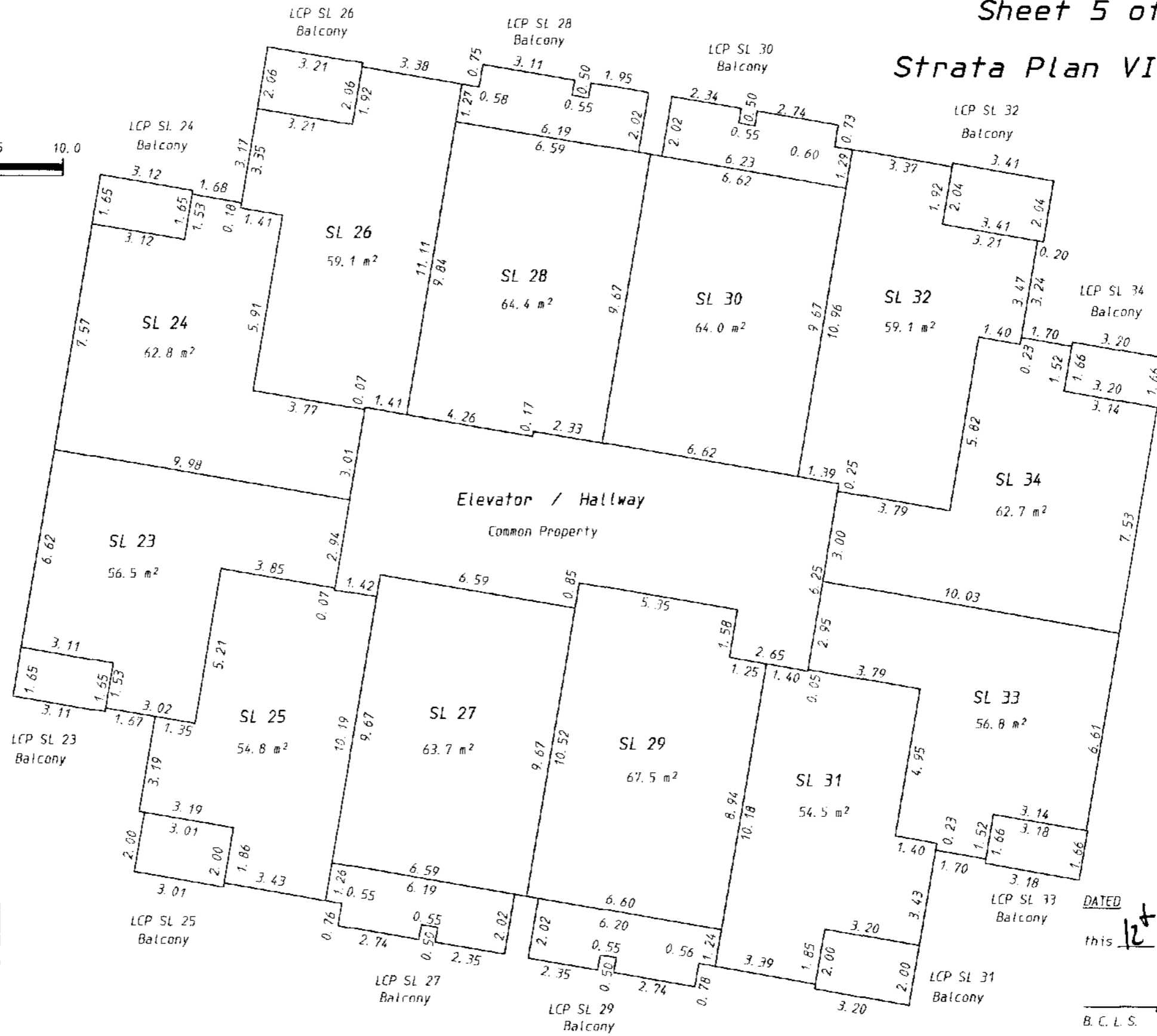
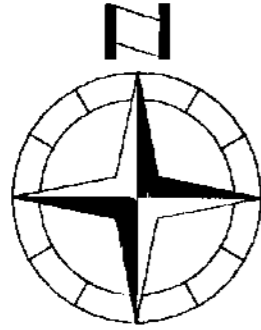

**Richard J. Wey & Associates**  
Land Surveying Inc.  
4 - 2227 James White Blvd., Sidney, B.C.  
Telephone (250) 656-5155  
File: rich-971972e.str

DATED this 12<sup>th</sup> day of October 2004

B. C. L. S.

# Lower Fifth Floor

Scale = 1:150

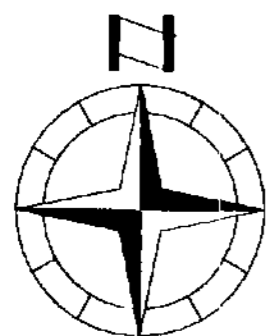
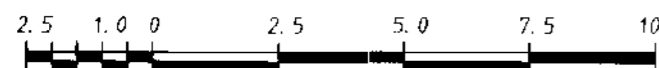

Sheet 6 of 8 Sheets  
 Strata Plan VIS **5679**

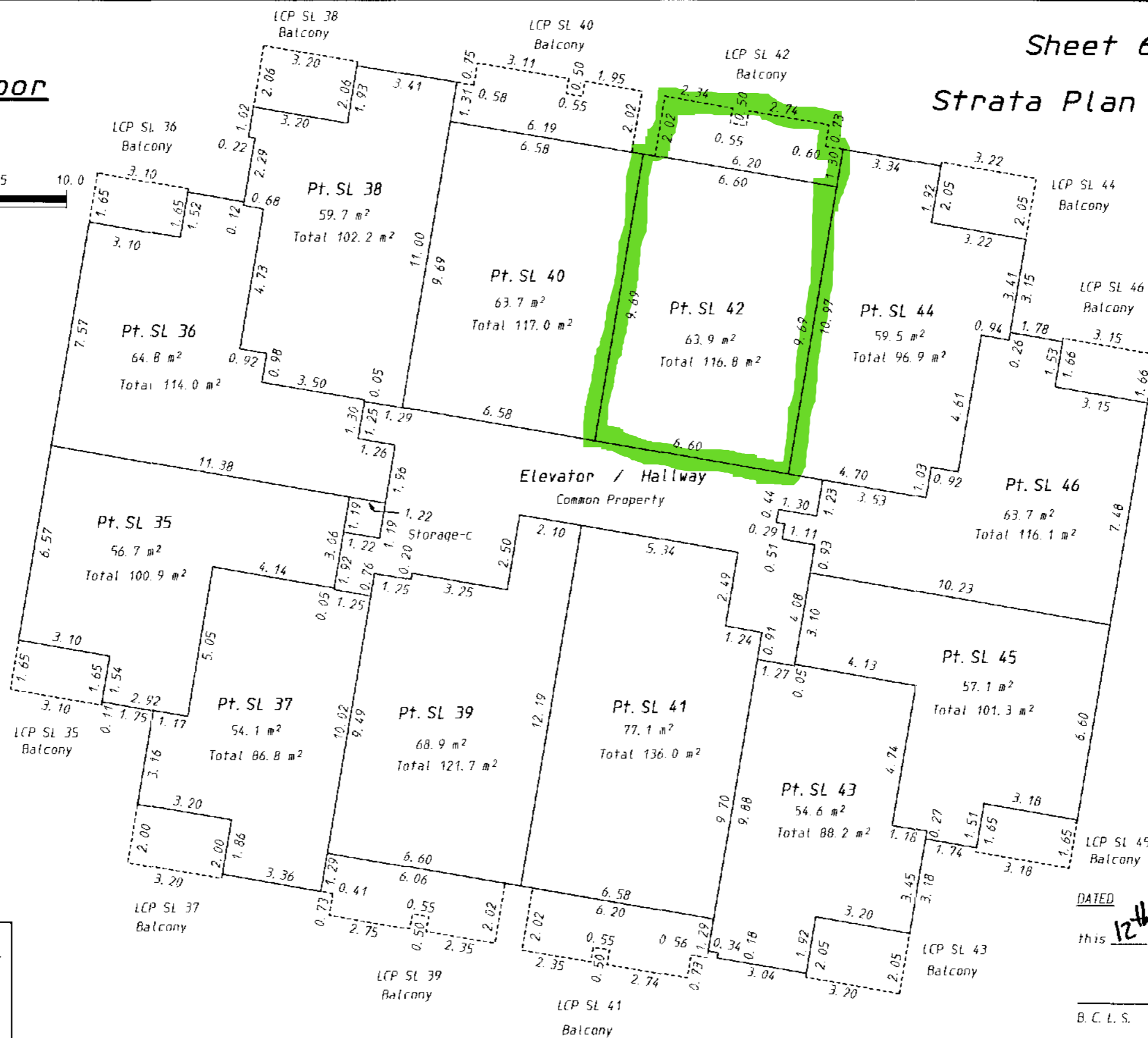

**Richard J. Wey & Associates**  
 Land Surveying Inc.  
 4 - 2227 James White Blvd., Sidney, B.C.  
 Telephone (250) 656-5155  
 File: Rich-971972f.str

DATED  
 this 12<sup>th</sup> day of October 2004  
 B.C.L.S.

# Upper Fifth Floor

Scale = 1:150



Sheet 7 of 8 Sheets

## Strata Plan VIS 5679

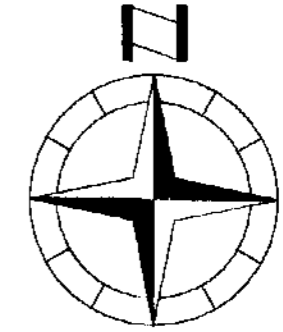
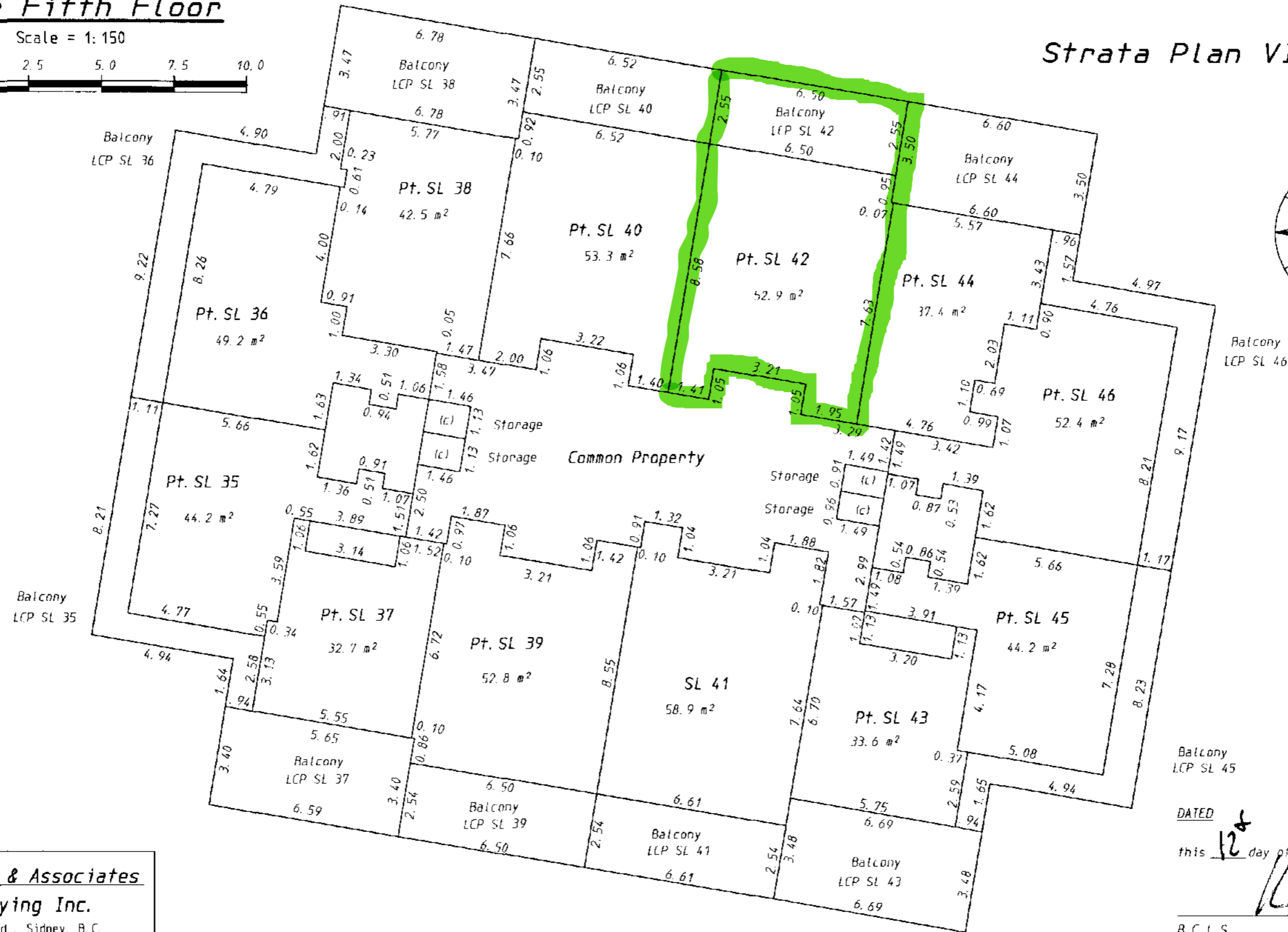

DATED this 12<sup>th</sup> day of October 2004

B. C. L. S.

**Richard J. Wey & Associates**  
**Land Surveying Inc.**  
 4 - 2227 James White Blvd., Sidney, B.C.  
 Telephone (250) 656-5155  
 File: rich-971972g.str

# Roof Deck

Scale = 1:150

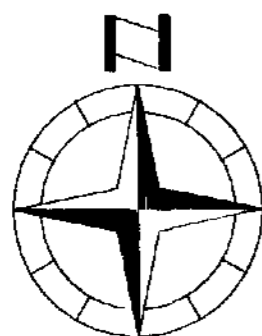

Sheet 8 of 8 Sheets

## Strata Plan VIS 5679

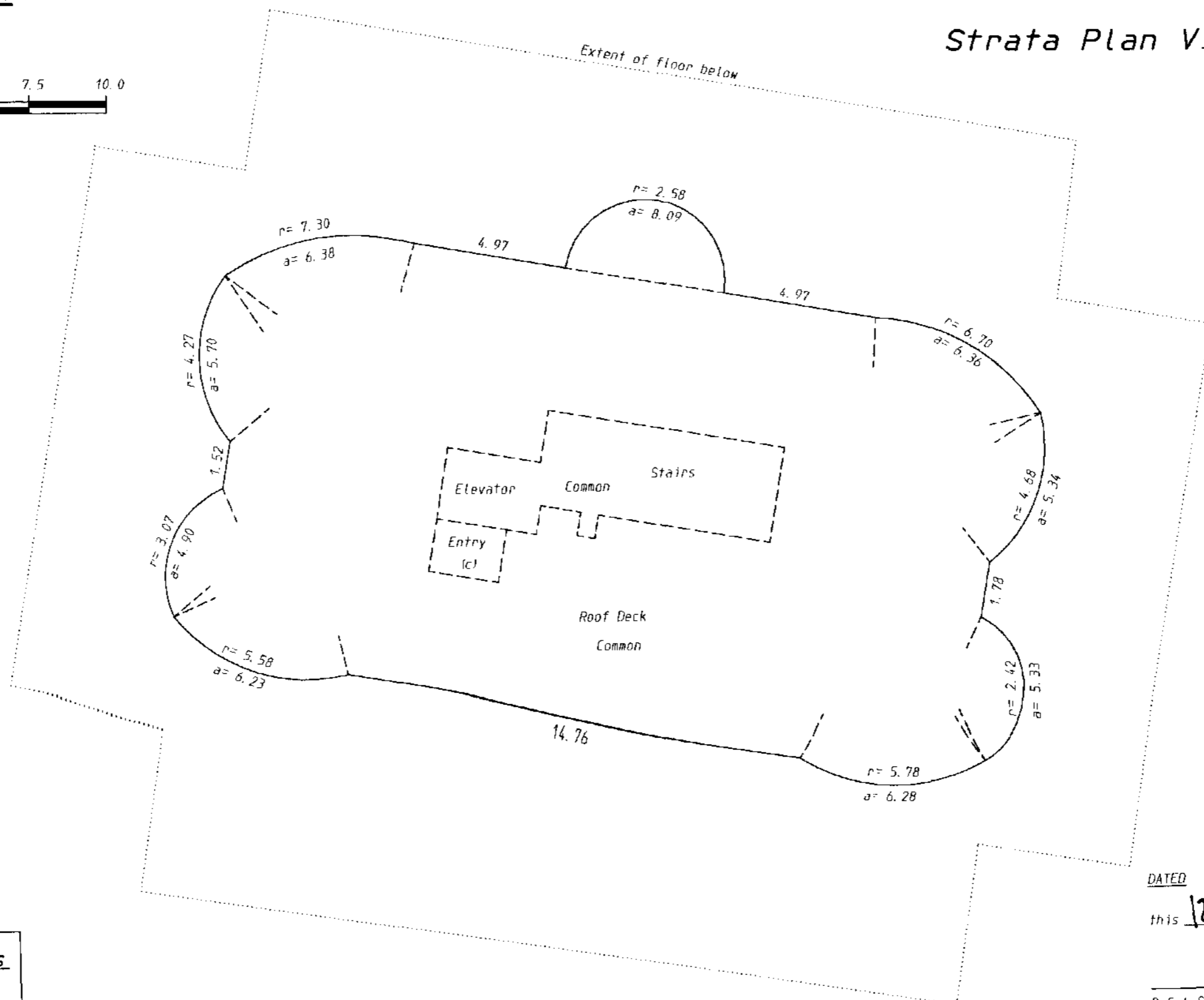

DATED  
 this 12<sup>th</sup> day of October 2004

B. C. L. S.

**Richard J. Wey & Associates**  
**Land Surveying Inc.**  
 4 - 2227 James White Blvd., Sidney, B.C.  
 Telephone (250) 656-5155  
 File: 971972b.str