

# Foundation Pro

Foundation Repair • Crawl Space Services • Concrete Raising • Drainage



**Date Prepared:** 05/13/2021

**ID:** OP18584-632

**Project Address:**

4316 Valley View Drive  
Little Rock, AR 72212

**Prepared By:**

Larry Fields  
Sales  
(501) 350-9919  
larry@foundationproar.com

## Service Agreement





**Service Agreement**

**Date:** 05/13/2021

Foundation Pro, enters into this agreement to provide labor, equipment, and materials for the repairs listed below and shown on the attached drawing at **4316 Valley View Drive Little Rock, AR 72212**. This agreement, **OP18584-632** and its prices herein, are valid until **5/28/2021**.

**Customer Info**

**Billing Address:**  
 4316 Valley View Drive  
 Little Rock, AR 72212

**Property Address:**  
 4316 Valley View Drive  
 Little Rock, AR 72212

**Repair Plan**

Code	Product Description	QTY	Units	Unit Price(\$)	Total(\$)	Description Detail (see warranty detail below)
GC-SP	Interior Adjustable Steel Pier	2	Each	\$750.21	\$1,500.41	- : Floor Adjustment – Stabilize Only : Foundation Type – New Concrete Poured Foundation : Warranty – TWO YEAR WARRANTY - FULLY TRANSFERABLE AT NO CHARGE : Product – Included

**Additional Remarks**

**Agreement Total**

**Total Amount:** \$1,500.41  
**Down Payment:** \$0.00  
**Balance Due:** \$1,500.41

*Credit Card Payments are subject to a 2% processing fee*  
 \*Balance due: **Upon Completion**

*Complete the above within approximately working days.*

**Transferable Warranty Detail: OP18584-632**

*Transferable warranty(ies) associated with the service code(s) provided above:*

Code	Detail
GC-SP	TWO YEAR WARRANTY - FULLY TRANSFERABLE AT NO CHARGE

**Addendum & Comments: OP18584-632**

*Repair Addendum & Comment(s) associated with the service code(s) provided above: Addenda to General Terms and Conditions Page*

Code	Comments
GC-SP	The degree of lift and amount of correction can neither be predicted nor guaranteed. Foundation Pro is not responsible for any tile, carpet, paneling, drywall, interior damage, appliances, HVAC systems, etc., That may result from correction.

**Addendum & Comments: OP18584-632**



**To expedite your project, at your earliest convenience:** Reference materials attached...

1. Print out the attached contract / Sign all necessary items / Scan or take a picture of signed documents / Email signed documents to: **FoundationProAR@gmail.com**
2. Place deposit and copy of the signed contract documents in mail to our corporate office:  
**Foundation Pro**  
**1500 N Locust St**  
**North Little Rock, AR 72114**

**Foundation Pro Scheduling Policy:**

- Priority is based on received deposit, unless other arrangements have been made in advance.
- An estimated scheduling window is issued at the time of the provided estimate (**Your Est. Schedule is:** ).
- Weather is a major contributing factor and can prolong the estimated scheduling window by several weeks.
- Utility location services are another contributing factor beyond our control.
- Due to these factors, our scheduling department will call up to two weeks prior with a firm start date.
- This date is still dependent upon the aforementioned factors.
- If any deviation from the firm date is necessary, you will be contacted immediately.

**Agreement Acceptance**

The prices (\$1,500.41), specifications and conditions on this agreement **OP18584-632** dated: **05/28/2021** are satisfactory and are hereby accepted. Foundation Pro is authorized to do the work as specified at this location: **4316 Valley View Drive Little Rock, AR 72212**. To receive "Warranty in good standing Certificate". I agree to the Final Payment terms. I understand that failure to pay Foundation Pro shall result in voiding of all warranties. I also understand that failure to pay Foundation Pro may result in my assuming any legal fees associated with Foundation Pro's attempt to collect my unpaid balance. BY signing this agreement, you acknowledge that you have received and reviewed the following attached documents: Cover Page, Repair Plan, Addendum & Comments, Terms and Conditions, Contract Diagram, Agreement Acceptance, and, product cut sheets.

**Signature**

**Foundation Pro Representative Signature**

---

4316 Valley View Drive  
Little Rock, AR 72212

*Larry Fields*

---

**Larry Fields**  
larry@foundationproar.com  
(501) 350-9919

**Date:**

05/13/2021

**Buyer's Right to Cancel**

Foundation Pro reserves the right to cancel a project due to weather, strikes, or other unforeseen circumstances beyond our control. Should Foundation Pro cancel a project, full refunds will be made. Cancellations must be received in writing, you may use this page or your project id as written notice with the addition: "I hereby cancel" in the subject line: Emailed, Faxed, or Mailed Attn. Scheduling:

**Email:** FoundationProAR@gmail.com  
**Foundation Pro**  
**1500 N Locust St**  
**North Little Rock, AR 72114**

- \*Cancellations prior to five business day before the scheduled start date will receive a full refund.
- \*Cancellations made less than five business days from the scheduled start date will receive a credit for future projects.
- \*Please allow two weeks for processing.



## GENERAL TERMS AND CONDITIONS

### GENERAL LIMITATIONS OF WORK: OP18584-632

Foundation Pro guarantees all material is to be as specified. All work to be completed in a workmanlike manner according to standard practices. Assume normal construction and that no unforeseen condition exists. For example, but not limited to; concrete thickness, unmarked utilities, mis-marked utilities, unidentified utilities, previous repairs, excess excavation, unconventional fill materials, etc. If this is not the case an additional agreed upon charge will be made to prepare the affected area for proper installation. Any alteration or deviation from above specifications involving extra costs will be executed only upon written orders and will become an extra charge over and above this agreement.

Customer acknowledges that the work being performed is a major repair and separation in plumbing may exist prior to work and/or may occur as a result of the work. The customer releases Foundation Pro from all responsibility for any damage to plumbing or consequential damages from plumbing leaks. Customer further acknowledges that damage may occur to tile, carpet, paneling, drywall, items exposed to excessive dust, interior / exterior damage, appliances, air conditioners, utilities, structure, property, etc. as a result of excavation or installation and that Foundation Pro is not responsible unless damage is the result of gross negligence or willful act. Nothing in this agreement shall be constituted to provide any warranty for water intrusion to the property, unless identified in the repair plan. Foundation Pro does NOT guarantee the survival of outside plants encountered or that need to be removed and replaced during and after the install process.

Foundation Pro is not responsible for radon, mold, water entering the premises through or over windows or any point above ground level, chimney, doors, broken water lines, blockage or back up, condensation, floods, electrical failure, tornados, earthquakes, hurricanes or drought.

All cosmetic repairs are considered maintenance items and are covered for a period of one year. Cosmetic repairs are not included in our limited warranty. For example, but not limited to; caulking, sealing, tuck-pointing, concrete replacement, patch work, fill materials, etc. Price does not include the addition of any soils due to subsidence or settlement unless otherwise stated in the agreement.

All agreements contingent upon strikes, accidents, weather conditions, or delays beyond our control. Owner to carry fire, tornado, and other necessary insurance. Our workers are fully covered by Worker's Compensation insurance.

Customer is to make all contracted areas available for service unless otherwise stated in this agreement.

### LIMITED WARRANTY

The work to be performed under this agreement is guaranteed for twelve months, standard construction warranty, unless otherwise stated. Warranty transfers must be executed within two weeks of closing. Extended warranties may be purchased anytime upon inspection.

If there is failure within the areas outlined in this agreement other than that effected by earthquake, change in soil conditions, change in slope, wind, flood, extreme change in water table, other act of God, or any similar man-made condition such as but not limited to; structure additions, structural repairs, landscape changes, etc.. then Foundation Pro will, at no cost or expense to you, correct any defect in workmanship or material that may have occurred in order to repair such area. THE FOREGOING IS OUR SOLE WARRANTY. ALL OTHER WARRANTIES, EXPRESSED OR IMPLIED, INCLUDING ANY WARRANTY OF MERCHANTABILITY AND WARRANTY OF FITNESS FOR PURPOSE, ARE EXCLUDED. Your exclusive remedy shall be for correction as outlined in this agreement and excludes any or all consequential damages. The owner acknowledges that the total extent of Foundation Pro liability shall not exceed this contract's accepted total.

### WARRANTY TERMS

"Warranty in good standing Certificate" Failure to pay Foundation Pro as required by this agreement shall result in the voiding of all guarantees/warranties. In addition, interest may be charged on any outstanding balances at the rate of 20% annually or a lesser amount which would be the maximum amount allowable by law. Legal and/or collection fees may also be added to any outstanding balances.

### BUYER'S RIGHT TO INDEPENDENT CONSULTATION

IT HAS BEEN EXPLAINED AND RECOMMENDED TO BUYER THAT THEY MAY WISH TO CONSULT WITH AN INDEPENDENT ENGINEER AND/OR LEGAL COUNSEL BEFORE SIGNING THIS AGREEMENT. PERMITS AND ENGINEERING COST ARE NOT INCLUDED UNLESS OTHERWISE NOTED IN THIS SERVICE AGREEMENT.

### BUYER'S RIGHT TO CANCEL

Foundation Pro reserves the right to cancel a project due to weather, strikes, or other unforeseen circumstances beyond our control. Should Foundation Pro cancel a project, full refunds will be made. Cancellations must be received in writing, you may use this page or your project id as written notice with the addition: "I hereby cancel" in the subject line: Emailed, Faxed, or Mailed Attn. Scheduling:

Email: [FoundationProAR@gmail.com](mailto:FoundationProAR@gmail.com)

Foundation Pro  
1500 N Locust St  
North Little Rock, AR 72114

\*Cancellations prior to five business day before the scheduled start date will receive a full refund.

\*Cancellations made less than five business days from the scheduled start date will receive a credit for future projects.

\*Please allow two weeks for processing.



OP18584-632

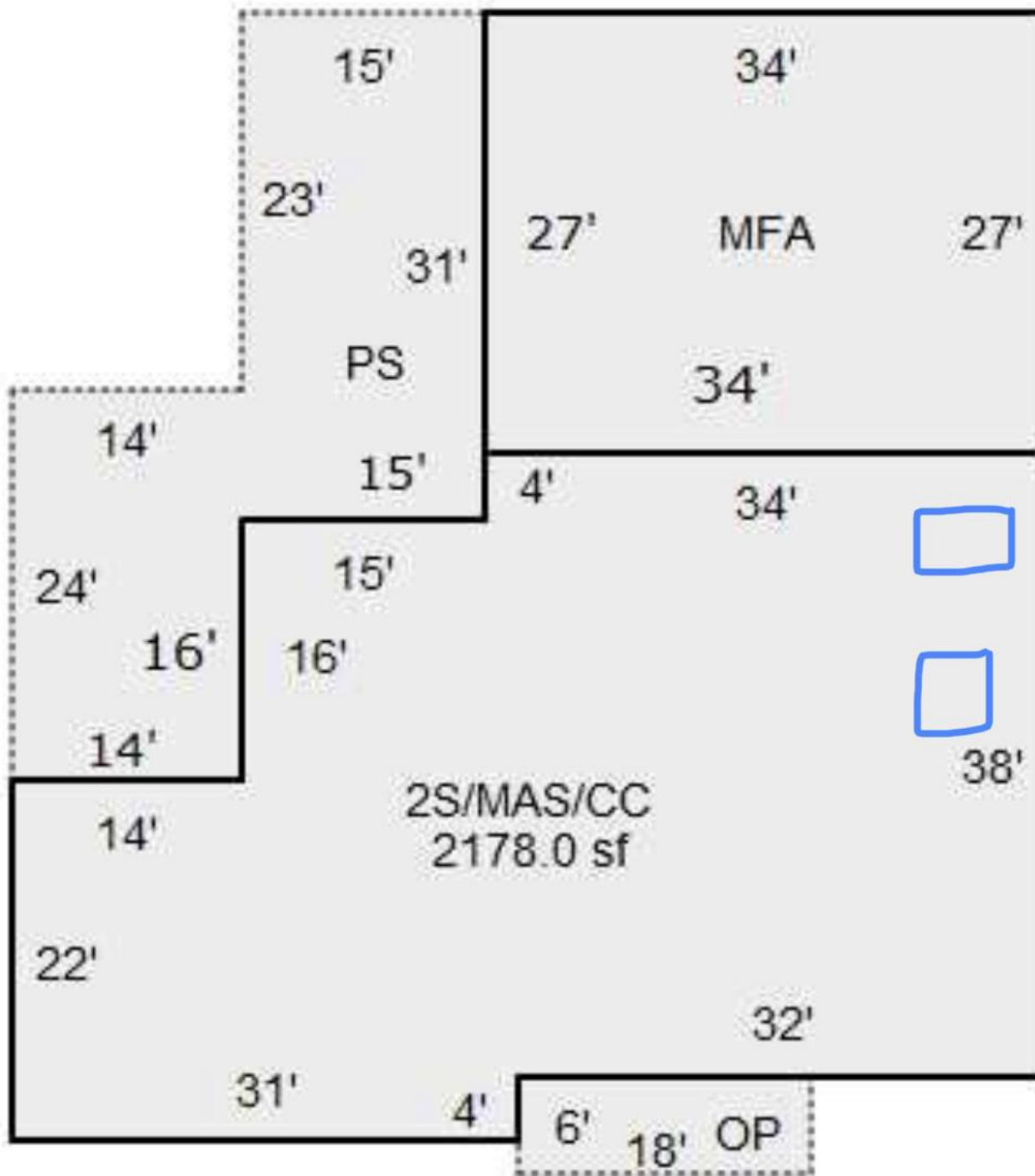





# Adjustable Steel Pier

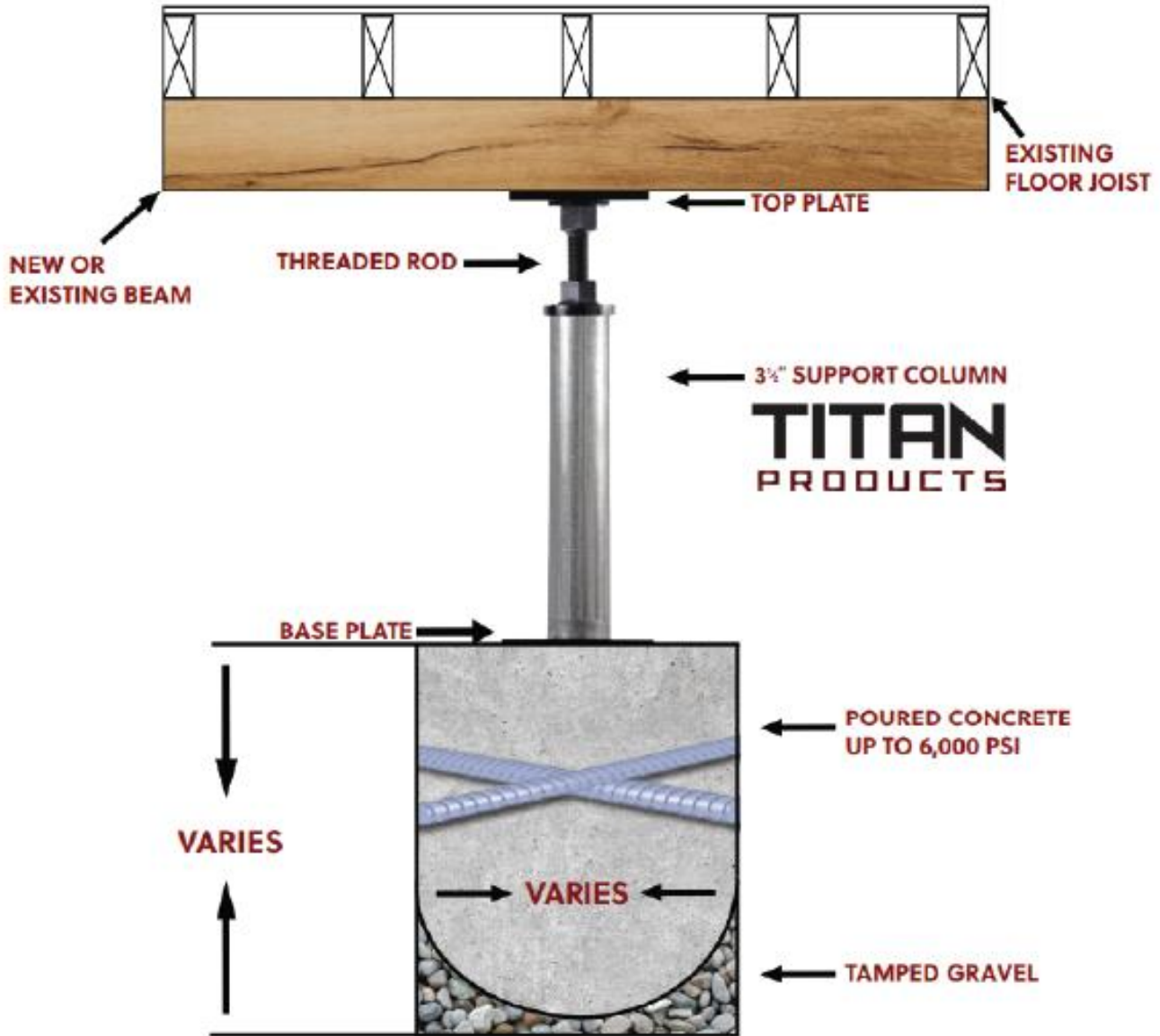

FULLY ADJUSTABLE + LIFT • NO RUST TECHNOLOGY

TITAN CRAWL JACK CAPACITY = 60 KIPS AT 8.75' OR SHORTER

TOTAL SYSTEM CAPACITY BASED ON FOOTING DESIGN





1500 N LOCUST ST • NORTH LITTLE ROCK, AR 72114  
Corporate Office: (501) 753-1009  
FoundationProAR@gmail.com • www.foundationproar.com

---