



## 60 Blueberry Ests, Prattsville, NY 12468

**\$109,900**

**ML#:** 155551

**Type:** Land

**Lot - Acres (approx):** 5.2800

**Lot - Sq Ft (approx):** 229997

Remarks - A Beautiful 5.28 Acre Parcel of Land on the Mountaintop in Prattsville! It's a great parcel in an ideal location for your dream home, cabin, cottage, campsite, or a recreation spot. The property has great proximity to the area's destinations and attractions as it's only 20 minutes to Windham Ski Mountain, 20 minutes to Windham Country Club, 20 minutes to Christman's Golf Course, 15 minutes to Main St. in Windham, & 5 minutes to the Schoharie Reservoir. It's a beautiful parcel on a charming country road in a memorable setting. View our 3D virtual sky tour and multi-media website.

View Virtual Tour and more details at:



**Ted Banta III**

**RVW Select Properties**

**Phone:** Primary:518-627-6290 Secondary:518-466-1219

**Email:** tedbanta3@yahoo.com

# Public Detail Report

Listings as of 12/17/24 at 2:10pm

**Active 12/17/24**      **Listing # 155551**      **60 Blueberry Ests, Prattsville, NY 12468 Map**      **Listing Price: \$109,900**  
**County: Greene**



|                       |             |                           |        |
|-----------------------|-------------|---------------------------|--------|
| <b>Property Type</b>  | Land        | <b>Property Subtype</b>   | Land   |
| <b>Town (Taxable)</b> | Prattsville |                           |        |
| <b>Tax Map ID</b>     | 57.00-2-15  | <b>Lot Sq Ft (approx)</b> | 229997 |
|                       |             | <b>Lot Acres (approx)</b> | 5.2800 |
| <b>DOM</b>            | 0           |                           |        |

[See Additional Pictures](#)

**School District** Gilboa

**Directions** From Main St., Prattsville, make a right onto Washington St, turn left onto Stanley Slater Rd, turn right onto Blueberry Est, property is on the right. It's across from 61 Blueberry Est.

**Marketing Remark** A Beautiful 5.28 Acre Parcel of Land on the Mountaintop in Prattsville! It's a great parcel in an ideal location for your dream home, cabin, cottage, campsite, or a recreation spot. The property has great proximity to the area's destinations and attractions as it's only 20 minutes to Windham Ski Mountain, 20 minutes to Windham Country Club, 20 minutes to Christman's Golf Course, 15 minutes to Main St. in Windham, & 5 minutes to the Schoharie Reservoir. It's a beautiful parcel on a charming country road in a memorable setting. View our 3D virtual sky tour and multi-media website.

**Special Conditions** None/Unknown

## General Information

**Ag District** No      **Flood Zone** No

## Property Features

|                        |                     |                   |   |
|------------------------|---------------------|-------------------|---|
| <b>Lot Size</b>        | 5.28 acres          | <b>Topography</b> | Flat, gentle slope                                |
| <b>% Wooded</b>        | %90.00              | <b>% Cleared</b>  | %10.00  |
| <b>Survey</b>          | No                  | <b>Zoning</b>     | 314 - Rural Vacant                                |
| <b>Paved Street</b>    | Yes                 | <b>Views</b>      | Country, Mountain, Neighborhood, Parklike, Wooded |
| <b>Internet Access</b> | Other (Vacant Land) | <b>Secluded</b>   | No  |
| <b>Road Frontage</b>   | Approximately 50'   | <b>Land Perc</b>  | No perc test has been performed                   |

## Public Records

|                   |          |                   |            |
|-------------------|----------|-------------------|------------|
| <b>School Tax</b> | \$223.76 | <b>Town Tax</b>   | \$273.00   |
| <b>Assessment</b> | \$18300  | <b>Assessors</b>  | \$28954.00 |
|                   |          | <b>FulMrktVal</b> |            |

**Tax Exemptions** No

## Utilities

|                 |         |              |      |
|-----------------|---------|--------------|------|
| <b>Water</b>    | None    | <b>Sewer</b> | None |
| <b>Electric</b> | On Road |              |      |

## Presented By:



December 2024

### Ted Banta III

Primary: 518-627-6290  
Secondary: 518-466-1219  
Other:

E-mail: tedbanta3@yahoo.com

Web Page: <https://rvwselectproperties.com/>

### RVW Select Properties

7 W Moorehouse Rd  
Cairo, NY 12413  
518-943-5303  
Fax : 866-466-9172

**See our listings online:**

<https://rvwselectproperties.com/>

Featured properties may not be listed by the office/agent presenting this brochure.

Information not guaranteed.

Copyright ©2024 Rapattoni Corporation. All rights reserved.

U.S. Patent 6,910,045



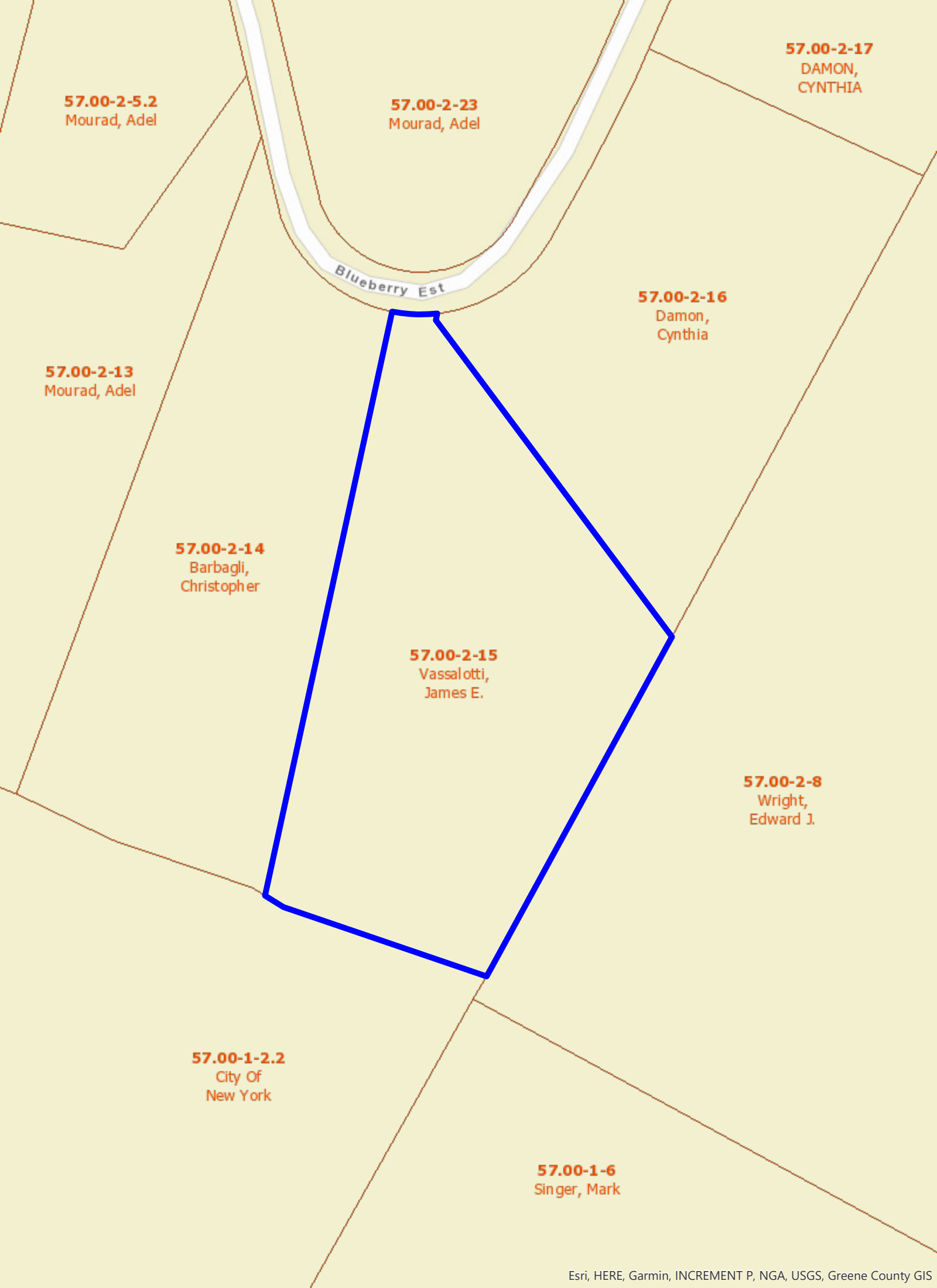

**57.00-2-5.2**  
Mourad, Adel

**57.00-2-23**  
Mourad, Adel

**57.00-2-17**  
DAMON,  
CYNTHIA

**57.00-2-16**  
Damon,  
Cynthia

**57.00-2-13**  
Mourad, Adel

**57.00-2-14**  
Barbagli,  
Christopher

**57.00-2-15**  
Vassalotti,  
James E.

**57.00-2-8**  
Wright,  
Edward J.

**57.00-1-2.2**  
City Of  
New York

**57.00-1-6**  
Singer, Mark

Blueberry Est





57.00-2-5.2  
Mourad, Adel

57.00-2-23  
Mourad, Adel

57.00-2-17  
DAMON,  
CYNTHIA

57.00-2-13  
Mourad, Adel

57.00-2-16  
Damon,  
Cynthia

57.00-2-14  
Barbagli,  
Christopher

57.00-2-15  
Vassalotti,  
James E.

57.00-2-8  
Wright,  
Edward J.

57.00-1-2.2  
City Of  
New York

57.00-1-6  
Singer, Mark



Greene County



Image Mate Online

Details for Taxes Levied in 2024

|               |
|---------------|
| Tax Links     |
| Property Info |
| Tax Info      |

Municipality of Prattsville

|       |        |              |            |
|-------|--------|--------------|------------|
| Swis: | 194400 | Tax Map ID#: | 57.00-2-15 |
|-------|--------|--------------|------------|

| 2024 County/Town Taxes |                           |           |               |
|------------------------|---------------------------|-----------|---------------|
| Description            | Rate (per \$1000 or Unit) | Value     | Amount Due    |
| County Tax             | 4.048758                  | 18,300.00 | 74.09         |
| Town Tax               | 7.607053                  | 18,300.00 | 139.21        |
| Pratts Ambulance       | 2.232782                  | 18,300.00 | 40.86         |
| Pratts fire            | 1.029603                  | 18,300.00 | 18.84         |
|                        |                           |           | Total: 273.00 |

| 2024-25 School                          |
|---|
| No School tax information is available. |



Property and summary tax balance information for the selected parcel is shown to the right. Exemptions are displayed as well if they exist for the property.

You can view or hide tax bill detail and any payments by clicking the bar near the bottom of the page.

If the property appears in other tax years, you can quickly view the tax history for the property. Just select a tax year from the drop-down list at the top of the page.

To request a signed Tax Certification, click the "Request Signed Certificate" button at the bottom of the page.

[Re-enter search conditions](#)

For Tax Year:  ▼

Last Updated: 10/21/24 04:54 pm

|  |   |             |                        |             |                        |               |                      |                    |                               |           |                        |                 |                             |
|--|---|-------------|------------------------|-------------|------------------------|---------------|----------------------|--------------------|-------------------------------|-----------|------------------------|-----------------|-----------------------------|
| Owner:<br><a href="#">Vassalotti James E</a><br><a href="#">445 First Ave</a><br><a href="#">Telhan, NY 10803</a>  | Tax Map # <a href="#">57.00-2-15</a><br>Tax Bill # <a href="#">000709</a><br>Bank Code:<br>School Code: <a href="#">433401</a><br>Property Class: <a href="#">314</a> Tax Roll: <a href="#">1</a> |             |                        |             |                        |               |                      |                    |                               |           |                        |                 |                             |
| Location: <a href="#">Blueberry Est</a><br>SWIS: <a href="#">194400 Prattsville</a>  | Acreage: <a href="#">5.28</a><br>Frontage: Liber: <a href="#">1485</a><br>Depth: Page: <a href="#">186</a>  |             |                        |             |                        |               |                      |                    |                               |           |                        |                 |                             |
| <table border="1"> <tr><td>Full Value:</td><td><a href="#">28,594</a></td></tr> <tr><td>Assessment:</td><td><a href="#">18,300</a></td></tr> <tr><td>STAR Savings:</td><td><a href="#">0.00</a></td></tr> <tr><td><b>Tax Amount:</b></td><td><b><a href="#">223.76</a></b></td></tr> <tr><td>Tax Paid:</td><td><a href="#">223.76</a></td></tr> <tr><td><b>Balance:</b></td><td><b><a href="#">0.00</a></b></td></tr> </table> |   | Full Value: | <a href="#">28,594</a> | Assessment: | <a href="#">18,300</a> | STAR Savings: | <a href="#">0.00</a> | <b>Tax Amount:</b> | <b><a href="#">223.76</a></b> | Tax Paid: | <a href="#">223.76</a> | <b>Balance:</b> | <b><a href="#">0.00</a></b> |
| Full Value:  | <a href="#">28,594</a>  |             |                        |             |                        |               |                      |                    |                               |           |                        |                 |                             |
| Assessment:  | <a href="#">18,300</a>  |             |                        |             |                        |               |                      |                    |                               |           |                        |                 |                             |
| STAR Savings:  | <a href="#">0.00</a>  |             |                        |             |                        |               |                      |                    |                               |           |                        |                 |                             |
| <b>Tax Amount:</b>   | <b><a href="#">223.76</a></b>   |             |                        |             |                        |               |                      |                    |                               |           |                        |                 |                             |
| Tax Paid:  | <a href="#">223.76</a>  |             |                        |             |                        |               |                      |                    |                               |           |                        |                 |                             |
| <b>Balance:</b>  | <b><a href="#">0.00</a></b>   |             |                        |             |                        |               |                      |                    |                               |           |                        |                 |                             |

(Hide Bill and Payment Details...)

| Tax Description | Tax Levy  | Taxable Value | Rate / 1000 | Tax Amount |
|-----------------|-----------|---------------|-------------|------------|
| School Tax      | 7,119,536 | 18,300        | 12.22756    | 223.76     |

| Pmt Date | Payor              | Check # | Tax Paid | Fees Paid |
|----------|--------------------|---------|----------|-----------|
| 10/02/24 | James E Vassalotti | 1196    | 223.76   |           |

**Tax Balance does not include any accrued Late Fees**  
**Payments shown may not include**  
**payments made directly to the County**

[Late Fee Schedule](#)

[Request Certification](#)

## AGRICULTURAL DISTRICT DISCLOSURE FORM AND NOTICE 04/07

for property commonly known as: Blueberry Est, Prattsville, NY 12468 Tax map # 57.00-2-15

When any purchase and sale contract is presented for the sale, purchase, or exchange of real property located partially or wholly within an agricultural district established pursuant to the provisions of article 25-AA of the Agricultural and Markets law, the prospective grantor shall present to the prospective grantee a disclosure notice which states the following:

*It is the policy of this state and this community to conserve, protect and encourage the development and improvement of agricultural land for the production of food, and other products, and also for its natural and ecological value. This disclosure notice is to inform prospective residents that the property they are about to acquire lies partially or wholly within an agricultural district and that farming activities occur within the district. Such farming activities may include, but not be limited to, activities that cause noise, dust and odors.*

*Prospective residents are also informed that the location of property within an agricultural district may impact the ability to access water and/or sewer services for such property under certain circumstances. Prospective purchasers are urged to contact the New York State Department of Agriculture and Markets to obtain additional information or clarification regarding their rights and obligations under article 25-AA of the Agriculture and Markets Law.*

Such disclosure notice shall be signed by the prospective grantor and grantee prior to the sale, purchase or exchange of such real property.

Receipt of such disclosure notice shall be recorded on a property transfer report form prescribed by the state board of real property services as provided for in section three hundred thirty-three of the real property law.

Initial the following:

\_\_\_\_\_ The aforementioned property IS located in an agricultural district.

Initial IS NOT \_\_\_\_\_ The aforementioned property IS NOT located in an agricultural district.

JEV

I have received and read this disclosure notice.

|        |                           |            |           |      |
|--------|---------------------------|------------|-----------|------|
|        | Signed by:                |            |           |      |
| Seller | <i>James E Vassalotti</i> | 11/22/2024 | Purchaser | Date |
|        | C90BB763264E43B...        | Date       |           |      |

|        |      |           |      |
|--------|------|-----------|------|
| Seller | Date | Purchaser | Date |
|--------|------|-----------|------|



# Division of Licensing Services

New York State  
**Department of State**  
**Division of Licensing Services**  
 P.O. Box 22001  
 Albany, NY 12201-2001  
 Customer Service: (518) 474-4429  
 www.dos.ny.gov

## New York State Disclosure Form for Buyer and Seller

### THIS IS NOT A CONTRACT

*New York State law requires real estate licensees who are acting as agents of buyers or sellers of property to advise the potential buyers or sellers with whom they work of the nature of their agency relationship and the rights and obligations it creates. This disclosure will help you to make informed choices about your relationship with the real estate broker and its sales agents.*

*Throughout the transaction you may receive more than one disclosure form. The law may require each agent assisting in the transaction to present you with this disclosure form. A real estate agent is a person qualified to advise about real estate.*

*If you need legal, tax or other advice, consult with a professional in that field.*

### Disclosure Regarding Real Estate Agency Relationships

#### Seller's Agent

A seller's agent is an agent who is engaged by a seller to represent the seller's interests. The seller's agent does this by securing a buyer for the seller's home at a price and on terms acceptable to the seller. A seller's agent has, without limitation, the following fiduciary duties to the seller: reasonable care, undivided loyalty, confidentiality, full disclosure, obedience and duty to account. A seller's agent does not represent the interests of the buyer. The obligations of a seller's agent are also subject to any specific provisions set forth in an agreement between the agent and the seller. In dealings with the buyer, a seller's agent should (a) exercise reasonable skill and care in performance of the agent's duties; (b) deal honestly, fairly and in good faith; and (c) disclose all facts known to the agent materially affecting the value or desirability of property, except as otherwise provided by law.

#### Buyer's Agent

A buyer's agent is an agent who is engaged by a buyer to represent the buyer's interest. The buyer's agent does this by negotiating the purchase of a home at a price and on terms acceptable to the buyer. A buyer's agent has, without limitation, the following fiduciary duties to the buyer: reasonable care, undivided loyalty, confidentiality, full disclosure, obedience and duty to account. A buyer's agent does not represent the interest of the seller. The obligations of a buyer's agent are also subject to any specific provisions set forth in an agreement between the agent and the buyer. In dealings with the seller, a buyer's agent should (a) exercise reasonable skill and care in performance of the

agent's duties; (b) deal honestly, fairly and in good faith; and (c) disclose all facts known to the agent materially affecting the buyer's ability and/or willingness to perform a contract to acquire seller's property that are not consistent with the agent's fiduciary duties to the buyer.

#### Broker's Agents

A broker's agent is an agent that cooperates or is engaged by a listing agent or a buyer's agent (but does not work for the same firm as the listing agent or buyer's agent) to assist the listing agent or buyer's agent in locating a property to sell or buy, respectively, for the listing agent's seller or the buyer agent's buyer. The broker's agent does not have a direct relationship with the buyer or seller and the buyer or seller cannot provide instructions or direction directly to the broker's agent. The buyer and the seller therefore do not have vicarious liability for the acts of the broker's agent. The listing agent or buyer's agent do provide direction and instruction to the broker's agent and therefore the listing agent or buyer's agent will have liability for the acts of the broker's agent.

#### Dual Agent

A real estate broker may represent both the buyer and the seller if both the buyer and seller give their informed consent in writing. In such a dual agency situation, the agent will not be able to provide the full range of fiduciary duties to the buyer and seller. The obligations of an agent are also subject to any specific provisions set forth in an agreement between the agent, and the buyer and seller. An agent acting as a dual agent must explain carefully to both the buyer and seller that the agent is acting for the other party as well. The agent should also explain the possible effects of dual representation, including that by consenting to the dual agency relationship the buyer and seller are giving up their right to undivided loyalty. A buyer or seller should carefully consider the possible consequences of a dual agency relationship before agreeing to such representation. A seller or buyer may provide advance informed consent to dual agency by indicating the same on this form.

#### Dual Agent with Designated Sales Agents

If the buyer and seller provide their informed consent in writing, the principals and the real estate broker who represents both parties as a dual agent may designate a sales agent to represent the buyer and another sales agent to represent the seller. A sales agent works under the supervision of the real estate broker. With the informed consent of the buyer and the seller in writing, the designated sales agent for the buyer will function as the buyer's agent representing the interests of and advocating on behalf of the buyer and the designated sales agent for the seller will



# New York State Disclosure Form for Buyer and Seller

function as the seller's agent representing the interests of and advocating on behalf of the seller in the negotiations between the buyer and seller. A designated sales agent cannot provide the full range of fiduciary duties to the landlord or tenant. A designated sales agent cannot provide full range of fiduciary duties to the buyer or seller. The designated sales agent must explain that like the dual agent

under whose supervision they function, they cannot provide undivided loyalty. A buyer or seller should carefully consider the possible consequences of a dual agency relationship with designated sales agents before agreeing to such representation. A seller or buyer provide advance informed consent to dual agency with designated sales agents by indicating the same on this form.

This form was provided to me by Theodore Banta III & Konrad Roman of RVW Select Properties  
*(Print Name of Licensee)* *(Print Name of Company, Firm or Brokerage)*

a licensed real estate broker acting in the interest of the:

Seller as a *(check relationship below)*

Seller's Agent

Broker's Agent

Buyer as a *(check relationship below)*

Buyer's Agent

Broker's Agent

Dual Agent

Dual Agent with Designated Sales Agent

For advance informed consent to either dual agency or dual agency with designated sales agents complete section below:

Advance Informed Consent Dual Agency

Advance Informed Consent to Dual Agency with Designated Sales Agents

If dual agent with designated sales agents is indicated above: \_\_\_\_\_ is appointed to represent the buyer; and \_\_\_\_\_ is appointed to represent the seller in this transaction.

(I) (We) James E. Vassalotti acknowledge receipt of a copy of this disclosure form:

Signature of  Buyer(s) and/or  Seller(s):

\_\_\_\_\_  
\_\_\_\_\_

Signed by:  
James E Vassalotti  
C90BB763264E43B...

Date: \_\_\_\_\_

Date: 11/22/2024



## Division of Licensing Services

New York State  
Department of State, Division of Licensing Services  
(518) 474-4429  
[www.dos.ny.gov](http://www.dos.ny.gov)

New York State  
Division of Consumer Rights  
(888) 392-3644

### **New York State Housing and Anti-Discrimination Disclosure Form**

Federal, State and local Fair Housing Laws provide comprehensive protections from discrimination in housing. It is unlawful for any property owner, landlord, property manager or other person who sells, rents or leases housing, to discriminate based on certain protected characteristics, which include, but are not limited to **race, creed, color, national origin, sexual orientation, gender identity or expression, military status, sex, age, disability, marital status, lawful source of income or familial status**. Real estate professionals must also comply with all Fair Housing Laws.

#### **Real estate brokers and real estate salespersons, and their employees and agents violate the Law if they:**

- Discriminate based on any protected characteristic when negotiating a sale, rental or lease, including representing that a property is not available when it is available.
- Negotiate discriminatory terms of sale, rental or lease, such as stating a different price because of race, national origin or other protected characteristic.
- Discriminate based on any protected characteristic because it is the preference of a seller or landlord.
- Discriminate by “steering” which occurs when a real estate professional guides prospective buyers or renters towards or away from certain neighborhoods, locations or buildings, based on any protected characteristic.
- Discriminate by “blockbusting” which occurs when a real estate professional represents that a change has occurred or may occur in future in the composition of a block, neighborhood or area, with respect to any protected characteristics, and that the change will lead to undesirable consequences for that area, such as lower property values, increase in crime, or decline in the quality of schools.
- Discriminate by pressuring a client or employee to violate the Law.
- Express any discrimination because of any protected characteristic by any statement, publication, advertisement, application, inquiry or any Fair Housing Law record.

#### **YOU HAVE THE RIGHT TO FILE A COMPLAINT**

**If you believe you have been the victim of housing discrimination** you should file a complaint with the New York State Division of Human Rights (DHR). Complaints may be filed by:

- Downloading a complaint form from the DHR website: [www.dhr.ny.gov](http://www.dhr.ny.gov);
- Stop by a DHR office in person, or contact one of the Division’s offices, by telephone or by mail, to obtain a complaint form and/or other assistance in filing a complaint. A list of office locations is available online at: <https://dhr.ny.gov/contact-us>, and the Fair Housing HOTLINE at (844)-862-8703.

You may also file a complaint with the NYS Department of State, Division of Licensing Services. Complaints may be filed by:

- Downloading a complaint form from the Department of State’s website [https://www.dos.ny.gov/licensing/complaint\\_links.html](https://www.dos.ny.gov/licensing/complaint_links.html)
- Stop by a Department’s office in person, or contact one of the Department’s offices, by telephone or by mail, to obtain a complaint form.
- Call the Department at (518) 474-4429.

There is no fee charged to you for these services. It is unlawful for anyone to retaliate against you for filing a complaint.



# Division of Licensing Services

New York State  
Department of State, Division of Licensing Services  
(518) 474-4429  
[www.dos.ny.gov](http://www.dos.ny.gov)

New York State  
Division of Consumer Rights  
(888) 392-3644

## New York State Housing and Anti-Discrimination Disclosure Form

For more information on Fair Housing Act rights and responsibilities please visit <https://dhr.ny.gov/fairhousing> and <https://www.dos.ny.gov/licensing/fairhousing.html>.

This form was provided to me by Theodore Banta III & Konrad Roman (print name of Real Estate Salesperson/  
Broker) of RVW Select Properties (print name of Real Estate company, firm or brokerage)

(I)(We) James E. Vassalotti

(Buyer/Tenant/Seller/Landlord) acknowledge receipt of a copy of this disclosure form:

Buyer/Tenant/Seller/Landlord Signature  Date: 11/22/2024  
Signed by: C90BB763264E43B...

Buyer/Tenant/Seller/Landlord Signature \_\_\_\_\_ Date: \_\_\_\_\_

Real Estate broker and real estate salespersons are required by New York State law to provide you with this Disclosure.